

APPENDIX G2

Premises: Mickeys Beach Bar & Restaurant and Cafe Patisserie Glacerie

Subject: **Premises licence application**

I have considered the proposal and the associated plans. At present I do not feel that there are adequate safeguards in place to prevent public nuisance so accordingly I would like to make a REPRESENTATION.

I am therefore proposing that additional measures are put in place to promote the prevention of public nuisance from this premises. The necessity of these measures are required due to a range of factors including: the addition of an outdoor events area, the location of the premises and the hours which the premises are operating.

Our aim is to ensure that the music noise level from the premises should not be audible within any noise sensitive premises (e.g. dwelling) with windows open for normal ventilation especially after 11pm.

In order to achieve this the following condition is recommended:

Between 07.00hrs – 23.00hrs, the noise climate of the surrounding area must be protected such that the A-weighted equivalent continuous noise level (LAeq) from music noise level emanating from the application site, as measured at monitoring points over any 15 minute period with entertainment taking place, must not increase by more than +5 dB at the agreed monitoring points when compared against the agreed comparable LAeq 15min, with no entertainment taking place.

Between 23.00hrs – 02.00hrs, the noise climate of the surrounding area must be protected such that the A-weighted equivalent continuous noise level (LAeq) emanating from the application site, as measured at monitoring points over any 15 minute period with entertainment taking place, must not increase at the agreed monitoring points when compared against the agreed comparable LAeq 15min, with no entertainment taking place.

Between 23.00hrs – 07.00hrs the unweighted (i.e. linear) equivalent noise level (LZeq) in the 63Hz – 125 Hz 1/1-Octave bands, measured using the "fast" time constant at the monitoring points, over any 15 minute period with entertainment taking place, must not increase when compared against the agreed comparable LZeq 15min, with no entertainment taking place.

To comply with these conditions we would expect a noise consultant to be appointed to determine the existing LAeq 15 minutes at the pre-agreed location with no noise entertainment taking place. I have attached a map of the monitoring points for measuring the LAeq 15 min and LZeq 15 min with entertainment taking place. We would require a copy of the monitoring results for approval prior the first use of the premises.

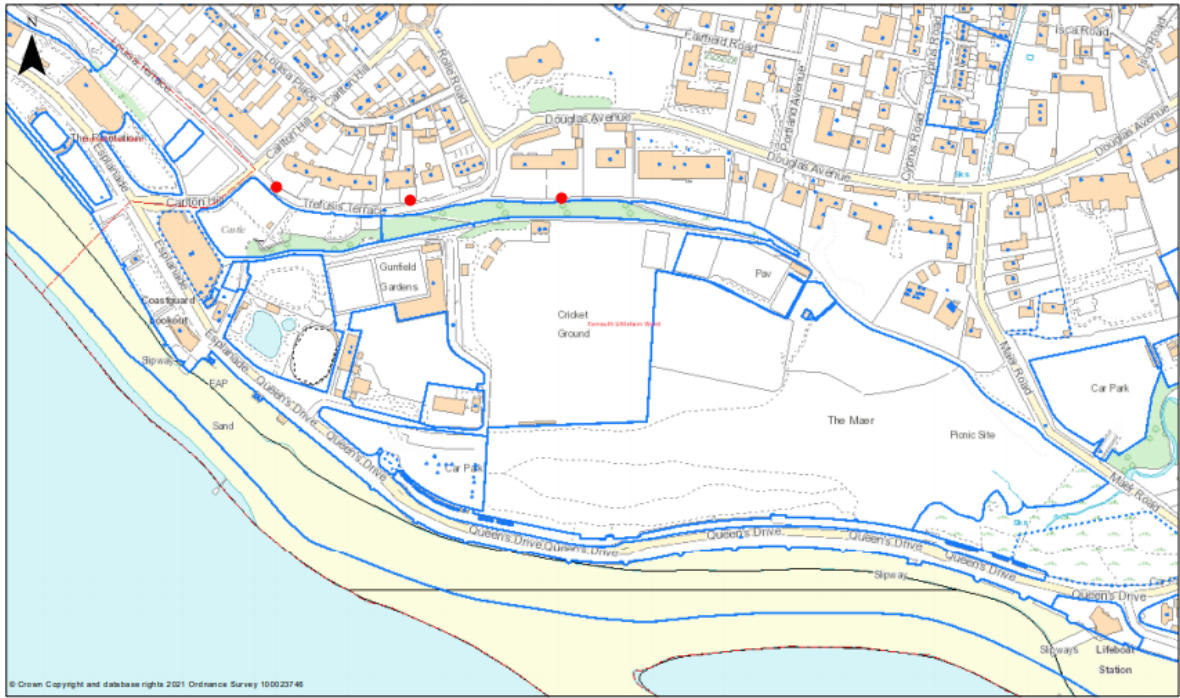

© Crown Copyright and database rights 2021 Ordnance Survey 100023746

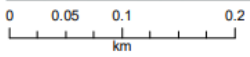

Map Tile: SY0080SE Full Reference: SY00659 80211

1:3,697

